

IP65 二相/三相混合式防水步进电机 (SIZE 57mm-1.8°/1.2°)



电机规格参数 (Motor Specifications)

型号(Model)	电流	电阻@20℃	电感@1kHz	保持力矩		惯量	机身長	重量	
	Current	Resistance	Inductance	Holding torque		Inertia	Length	Weight	
	A	$\Omega \pm 10\%$	mH $\pm 20\%$	N.m	OZ.in	g/cm ²	mm Max	Kg	Lbs
23IP270-01	1.0	5.8	21.0	1.2	170.0	280	65	0.7	1.5
23IP270-02	2.0	1.6	5.3	1.2	170.0	280	65	0.7	1.5
23IP270-03	3.0	0.7	2.4	1.2	170.0	280	65	0.7	1.5
23IP290-02	2.0	2.4	9.0	2.0	283.3	480	86	1.1	2.4
23IP290-03	3.0	1.1	4.2	2.0	283.3	480	86	1.1	2.4
23IP290-04	4.0	0.6	2.4	2.0	283.3	480	86	1.1	2.4
23IP370-01	2.5	0.9	1.5	1.0	141.6	280	65	0.7	1.5
23IP370-02	3.3	0.6	0.9	1.0	141.6	280	65	0.7	1.5
23IP390-01	2.5	1.4	2.6	1.8	255.0	480	90	1.1	2.4
23IP390-02	3.3	0.9	1.6	1.8	255.0	480	90	1.1	2.4

外形图 (Dimensions)

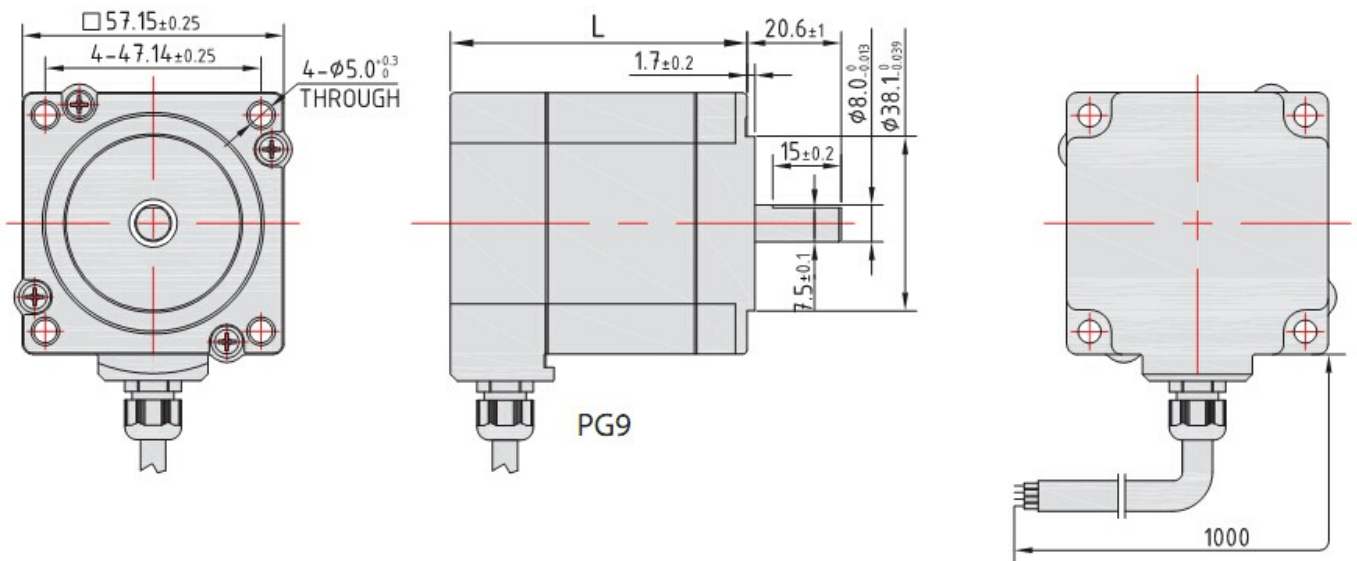

短频曲线 (Torque-frequency Curve)

